

WOOD NAILER BY OTHERS
(NOT BY ONEDEK® SUPPLIER)

NOTE: REFER TO DETAIL _E FOR EDGE
METAL ASSEMBLY INFORMATION.

NOTE: BUTYL SEALANT
AT WALL JOINERY NOT
SHOWN FOR CLARITY.
ENSURE ALL SEALANTS
MARRY TO CREATE A
THERMAL ENVELOPE.

FILL VOID WITH ONE-PART
EXPANDING FOAM SEALANT

WALL SYSTEM BY OTHERS
(NOT BY ONEDEK® SUPPLIER)

3" MIN.

HOT-AIR WELDED __ 45 MIL
REINFORCED FLASHING
ONEDEK® THERMOPLASTIC
ROOF MEMBRANE (SEE
"ONEDEK® ROOFING MEMBRANE"
FOR ATTACHMENT OPTIONS)

#12 - 24 x _" TRUFEST PURLIN
FASTENERS W/ "RP-01" ROOF
DECK PLATE (REFER TO RD1
FASTENING SYSTEM)

BUTYL TAPE

EAVE STRUT (NOT BY
ONEDEK® SUPPLIER)

GUTTER W/ PERIMETER EDGE METAL

(SECTION VIEW)



DETAIL: GUTTER W/ PERIMETER EDGE METAL

929 ALDRIDGE ROAD
VACAVILLE, CA 95688
TEL: (707) 359-2280
FAX: (707) 359-2286
WWW.AWIPANELS.COM

All Weather
Insulated Panels



DATE: 02/06/23
DRAWN BY: MMF

APPLICATION:
RD1 ROOF DECK, COMMERCIAL & INDUSTRIAL, COLD-STORAGE
AWIP DETAIL NUMBER:
RDR-C/ICS-WBO-004

SHEET:
1 OF 1

WOOD NAILER BY OTHERS
(NOT BY ONEDEK® SUPPLIER)

POLYETHER SEALANT

CB-90 TERMINATION BAR x 10'-0"

3" MIN.

HOT-AIR WELDED __ 45 MIL
REINFORCED FLASHING

ONEDEK® THERMOPLASTIC
ROOF MEMBRANE (SEE
"ONEDEK® ROOFING MEMBRANE"
FOR ATTACHMENT OPTIONS)

2-PIECE EXTRUDED
ALUM. BRACKET 1" WIDE
@ 2'-0" O/C

1 1/2" MIN. WELD (CONTINUOUS)

#14 x 1 1/2" UNIVERSAL
FASTENER 6" O/C

#14 x 1 1/2" UNIVERSAL
FASTENER 2'-0" O/C

WR GUTTER - 7 3/4", FORMED IN
12'-0" LENGTHS W/
CONCEALED SPLICES, 6" WIDE

WALL SYSTEM BY OTHERS
(NOT BY ONEDEK® SUPPLIER)

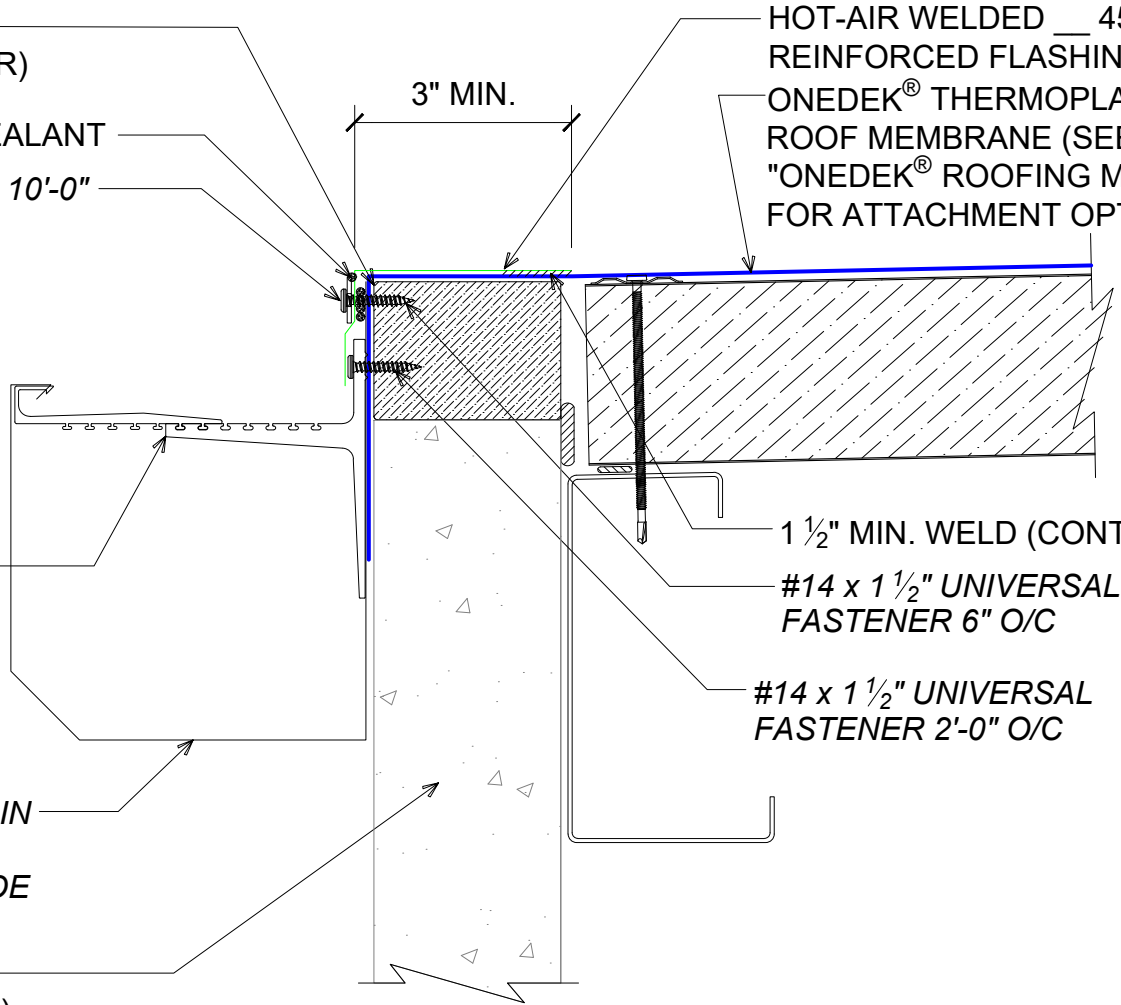

#E GUTTER W/ PERIMETER EDGE METAL

(SECTION VIEW)

DETAIL:

GUTTER W/ PERIMETER EDGE METAL, CHAMFER VERSION 7 3/4"

APPLICATION: RD1 ROOF DECK, COMMERCIAL & INDUSTRIAL, COLD-STORAGE

DATE: 02/06/23

DRAWN BY: MMF

929 ALDRIDGE ROAD
VACAVILLE, CA 95688
TEL: (707) 359-2280
FAX: (707) 359-2286
WWW.AWIPANELS.COM

