

FLEXIBLE WEATHERPROOF
MEMBRANE & LINER BY OTHERS
(NOT BY ONEDEK™ SUPPLIER)

"TC-03" TRIM CLEAT W/
STITCH TEKS 12" O/C

"BA-01" BASE ANGLE W/
#14 - 13 x 1½" TRUSS HEAD
TEK FASTENERS 12" O/C

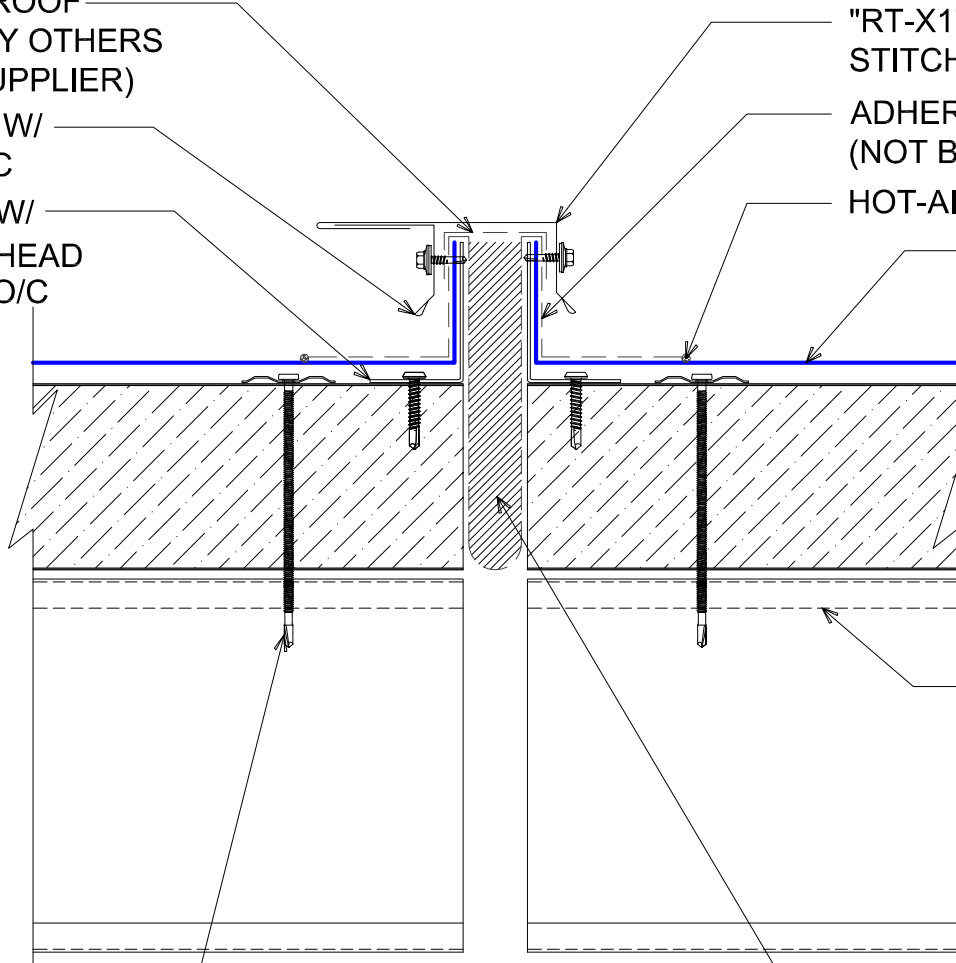

"RT-X1" ROOF TRANSITION TRIM W/
STITCH TEKS 12" O/C

ADHERED MEMBRANE FLASHING
(NOT BY ONEDEK™ SUPPLIER)

HOT-AIR WELDED SEAM

ONEDEK™
THERMOPLASTIC
ROOF MEMBRANE
(SEE "ONEDEK™
ROOFING MEMBRANE"
FOR ATTACHMENT
OPTIONS)

SECONDARY FRAMING
(NOT BY ONEDEK™
SUPPLIER)

#12 - 24 x _" TRUFast PURLIN
FASTENERS W/ "RP-01" ROOF DECK
PLATE _" O/C

COMPRESSIBLE INSULATION
(NOT BY ONEDEK™ SUPPLIER)

BASE FLASHING AT EXPANSION JOINT W/ METAL COVER

(SECTION VIEW)

DETAIL:

EXPANSION JOINT W/ METAL COVER

APPLICATION:

RD1 ROOF DECK, COMMERCIAL & INDUSTRIAL, COLD-STORAGE

AWIP DETAIL NUMBER:

RDR-CICS-EJ-001

DATE:

08/12/19

DRAWN BY:

MMF

SHEET:

1

OF

1

929 ALDRIDGE ROAD
VACAVILLE, CA 95688
TEL: (707) 359-2280
FAX: (707) 359-2286
WWW.AWIPANELS.COM

All Weather
Insulated Panels

