

All Weather Insulated Panels

Proven solutions for temperature-controlled environments



All Weather
Insulated Panels

Your vision. Our purpose.



Contents

Your vision. Our purpose.	3
Our Products	5
Mesa DM40	6
Mesa DM44	7
fiRe-rated Panels	8
OneDek® Insulated Roof Deck	9
Roofing	10
Floor Insulation	11
Accessories	12
BIM & Design Services	13
Colors & Finishes	14
Planet Passionate	15



All Weather Insulated Panels

Your vision. Our purpose.

All Weather Insulated Panels, an industry leader in foam composite insulated metal panels, offers proven solutions for temperature-controlled environments including cold storage freezers and coolers.

3

state-of-the-art manufacturing facilities with the world's most up-to-date lines

VACAVILLE, CA
LITTLE ROCK, AR
EAST STROUDSBURG, PA

AWIP: Our commitment

At All Weather Insulated Panels, we are strategically positioned to deliver customer service, quality and innovation while meeting the growing energy, environmental and economic challenges facing the North American building industry. These key tenets help us to exceed your expectations with a highly technical and resourceful team committed to working alongside you through the lifecycle of your projects.



220+

highly technical and resourceful employees working with you through your project's lifecycle:

- ACCOUNTABILITY
- INNOVATION
- INTEGRITY

Our Products



Our Products

From floor to roof and everywhere in between, All Weather Insulated Panels offers the total solution for your temperature-controlled storage needs. Discover our complete suite of wall products, underfloor insulation and accessories packages.

As building codes demand improved energy efficiency, All Weather Insulated Panels are the preferred choice for delivering the optimal thermal capabilities, design flexibility and building performance that eco-conscious builders, designers and owners require.

Product Features and Performance Benefits



Economical insulated metal panel for commercial, industrial and cold storage facilities

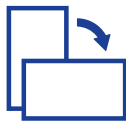

Panel joinery is designed to permit installation of the panel in a vertical or horizontal position



One panel total wall design includes exterior aesthetic, weather barrier, insulation and vapor barrier



High R-values up to R-57* for an 8" panel thickness provide long-term energy savings



Composite panel simplifies design, improves efficiency and reduces installation costs

*per ASTM C518 @ 75 degrees

Mesa DM40

The perfect economical choice for exterior and interior industrial and cold storage facilities is our Mesa (DM40) insulated metal panel. This panel is available in thicknesses up to 8 inches, offering outstanding thermal performance for cold storage buildings. Panels are embossed and lightly planked to provide a uniform exterior wall aesthetic. In addition, panels are available in standard lengths up to 50 feet long, which can minimize panel end joint conditions and improve installation time.

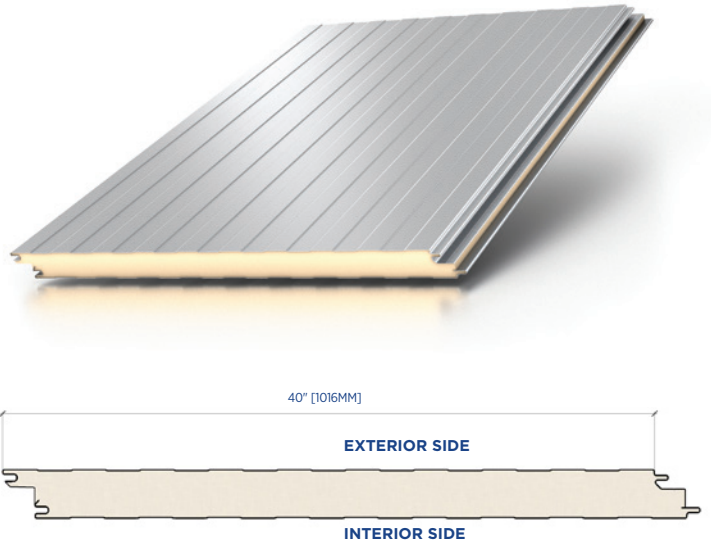

Product Specifications

Profile	Exterior	Embossed, Lightly Planked, Mesa Rib					
	Interior	Embossed, Lightly Planked, Mesa Rib					
Exterior Face Skin	26 Gauge G90/AZ50, Optional Gauges: 24 and 22 G90/AZ50, 26 3042B Stainless Steel*						
Interior Face Skin	26 Gauge G90/AZ50, Optional Gauges: 24 and 22 G90/AZ50, 26 3042B Stainless Steel						
Panel Module***	40"[1016mm]						
Lengths***	Minimum 8'[2.44m], Maximum: 50'[15.24m]						
Side Lap	Double Tongue and Groove						
Thermal Performance**							
Thickness	2"[51mm]	2.5"[64mm]	3"[76mm]	4"[102mm]	5"[127mm]	6"[152mm]	8"[203mm]
R-Value @ 75°F mean (°F·ft²·h/BTU)	14	18	21	28	36	43	57
U-Value @ 75°F mean (BTU/°F·ft²·h)	0.069	0.056	0.046	0.035	0.028	0.023	0.017
R-Value @ 35°F mean (°F·ft²·h/BTU)	16	20	24	32	41	49	65
U-Value @ 35°F mean (BTU/°F·ft²·h)	0.061	0.049	0.041	0.031	0.024	0.020	0.015

*For interior applications only

**Thermal values as tested per ASTM C518

***Contact AWIP for Custom Sizes

Mesa DM44

Designed for interior industrial and partition wall facilities, Mesa (DM44) is ideal for partition wall applications. With panels that are 4" wider, DM44 provides many benefits:

- R-values[†] from 16 to 65
- Excellent thermal performance
- 44" width means fewer panels for contractors to install

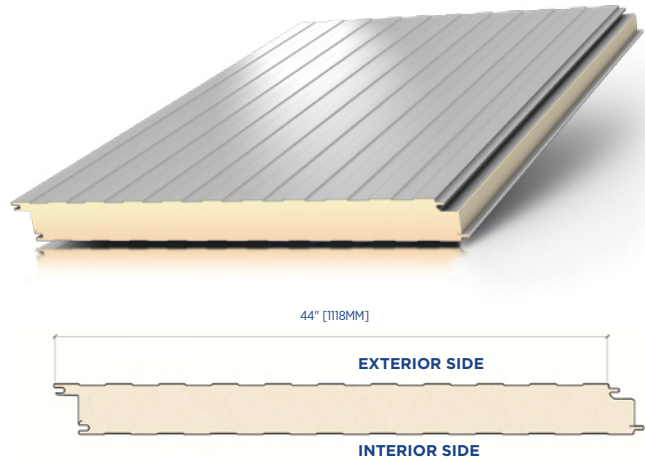

Product Specifications

Profile	Exterior	Embossed, Lightly Planked, Mesa Rib					
	Interior	Embossed, Lightly Planked, Mesa Rib					
Exterior Face Skin	26 Gauge G90/AZ50, Optional Gauges: 24 and 22 G90/AZ50, 26 304 2B Stainless Steel*						
Interior Face Skin	26 Gauge G90/AZ50, Optional Gauges: 24 and 22 G90/AZ50, 26 304 2B Stainless Steel						
Panel Module**	44"[1118mm]						
Lengths**	Minimum: 8'[2.44m], Maximum: 50'[15.24m]						
Side Lap	Double Tongue and Groove						
Thermal Performance[†]							
Thickness	2"[51mm]	2.5"[64mm]	3"[76mm]	4"[102mm]	5"[127mm]	6"[152mm]	8"[203mm]
R-Value @ 75°F mean (°F·ft²·h/BTU)	14	18	21	28	36	43	57
U-Value @ 75°F mean (BTU/°F·ft²·h)	0.069	0.056	0.046	0.035	0.028	0.023	0.017
R-Value @ 35°F mean (°F·ft²·h/BTU)	16	20	24	32	41	49	65
U-Value @ 35°F mean (BTU/°F·ft²·h)	0.061	0.049	0.041	0.031	0.024	0.020	0.015

* For interior applications only

** Contact AWIP for Custom Sizes

† Thermal values as tested per ASTM C518

fiRe-rated panels

For your cooler and freezer applications, look no further for a 1-Hour fire-rated wall with superior thermal performance compared to mineral fiber. Designed specifically for temperature-controlled environments, our 4.5-inch thick fiRe-rated wall panels are able to meet fire-rating requirements while still keeping the required R-value for cold storage.

Our fiRe 1-Hour rated panels are a composition of traditional building components that are factory assembled and delivered to the jobsite as a single component. This composite assembly yields a 1-Hour fire rating with R-values and the installation simplicity of an IMP.

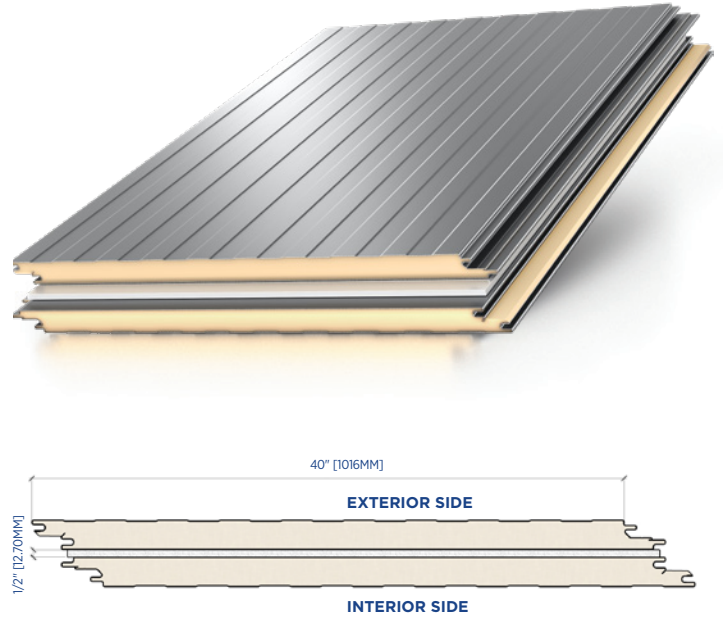

OneDek® Insulated Roof Deck

Ideal for freezer and cooler applications, OneDek is a high-performance, transformative alternative to traditional low-slope roofing systems.

An Ideal Choice

With speed, simplicity and innovation, OneDek is transforming the way roofs are installed in temperature-controlled environments. OneDek reduces project complexity by reducing the assembly steps required, thereby decreasing the installation time of the roof. Utilizing OneDek reduces the number of fasteners, risk of failure, number of trades, cost overruns, deliveries to site and on-site waste generation. Increase your efficiency with OneDek and install your project faster. The OneDek system is available with our 20-year no dollar limit (NDL) weather-tight roof warranty.

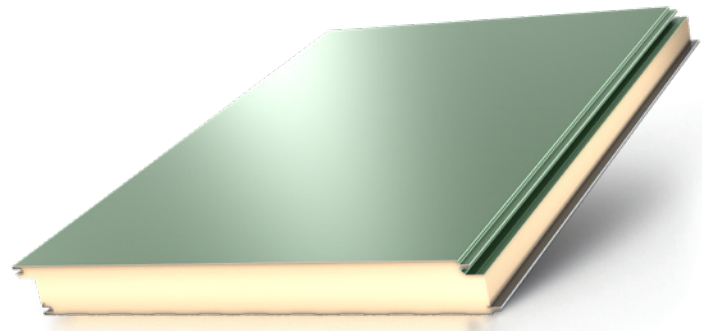

Product Specifications

Profile	Exterior	Smooth Flat				
	Interior	Embossed, Lightly Planked, Mesa Rib				
Exterior Face Skin	26 Gauge G90 Galvanized or AZ50 Galvalume. 24 and 22 Gauge optional					
Interior Face Skin	26 Gauge G90 Galvanized or AZ50 Galvalume. 24 and 22 Gauge optional, 26 304 2B Stainless Steel					
Slope Requirements	Minimum 1/4:12 slope, Maximum 1:12 TPO, 2:12 PVC					
Panel Module**	40"[1016mm]					
Lengths**	Minimum: 8'[2.44m], Maximum: 50'[15.24m]					
Side Lap	Double Tongue and Groove					
Thermal Performance†						
Thickness	2"[51mm]	2.5"[64mm]	3"[76mm]	4"[102mm]	5"[127mm]	6"[152mm]
R-Value @ 75°F mean (°F·ft²·h/BTU)	14	18	21	28	36	43
U-Value @ 75°F mean (BTU/°F·ft²·h)	0.069	0.056	0.046	0.035	0.028	0.023
R-Value @ 35°F mean (°F·ft²·h/BTU)	16	20	24	32	41	49
U-Value @ 35°F mean (BTU/°F·ft²·h)	0.061	0.049	0.041	0.031	0.024	0.020

** Contact AWIP for Custom Sizes
† Thermal values as tested per ASTM C518

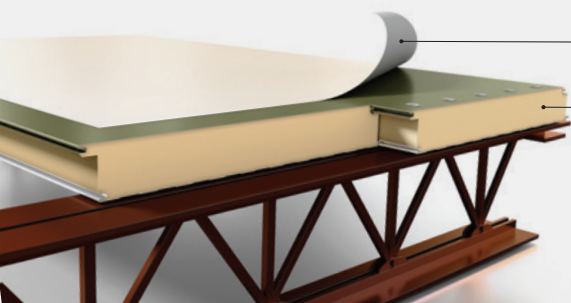

OneDek Field-Applied Membrane TPO or PVC
OneDek RD1

ONEDEK®
INSULATED ROOF DECK

Roofing

Designed to give the look of a traditional metal standing seam roof with all the benefits of an insulated metal panel, our roofing products allow for field seamed, hidden fastener joinery for protection against the elements, supported by a 20-year no dollar limit (NDL) weather tightness warranty.

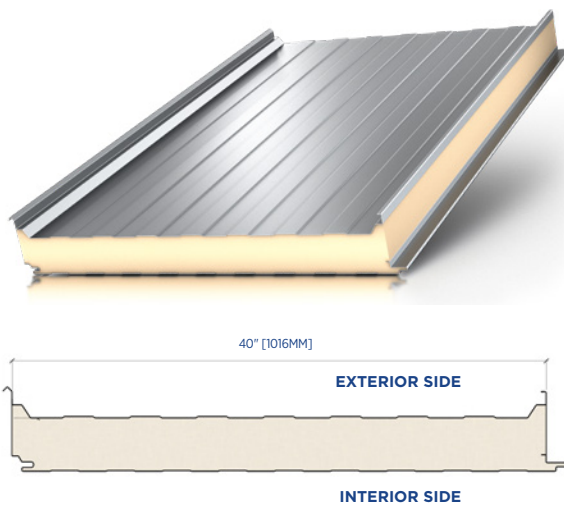

SR2 Standing Seam Roof Panel

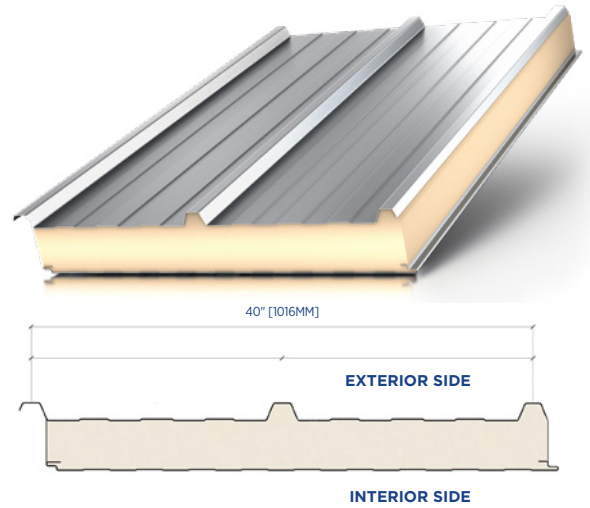

HR3 High Rib Roof Panel

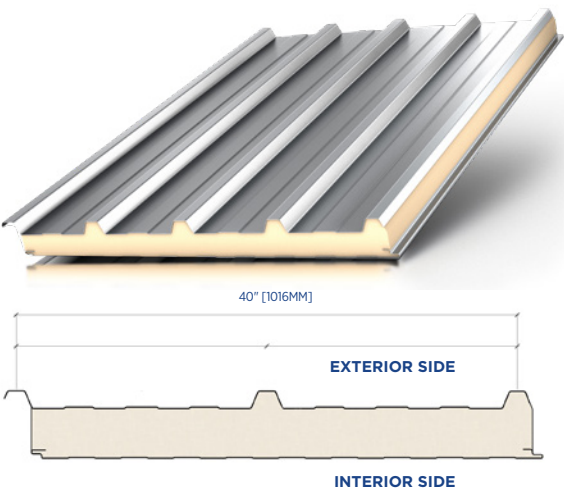

HR5 High Rib Roof Panel



Scan for the most current product information

Floor Insulation

GreenGuard Insulation Board

To supplement your cooler and freezer building envelope needs, we offer the GreenGuard Insulation Board suitable for normal loading situations, including cold-storage floors. With high water resistance and an R-value of 5.0 per inch of thickness, the GreenGuard Insulation Board is available in a square edge board, ship-lap edge board, or score-board. Easy to handle and to cut with a knife, lightweight XPS insulation exceeds all Type IV and Type X specifications.

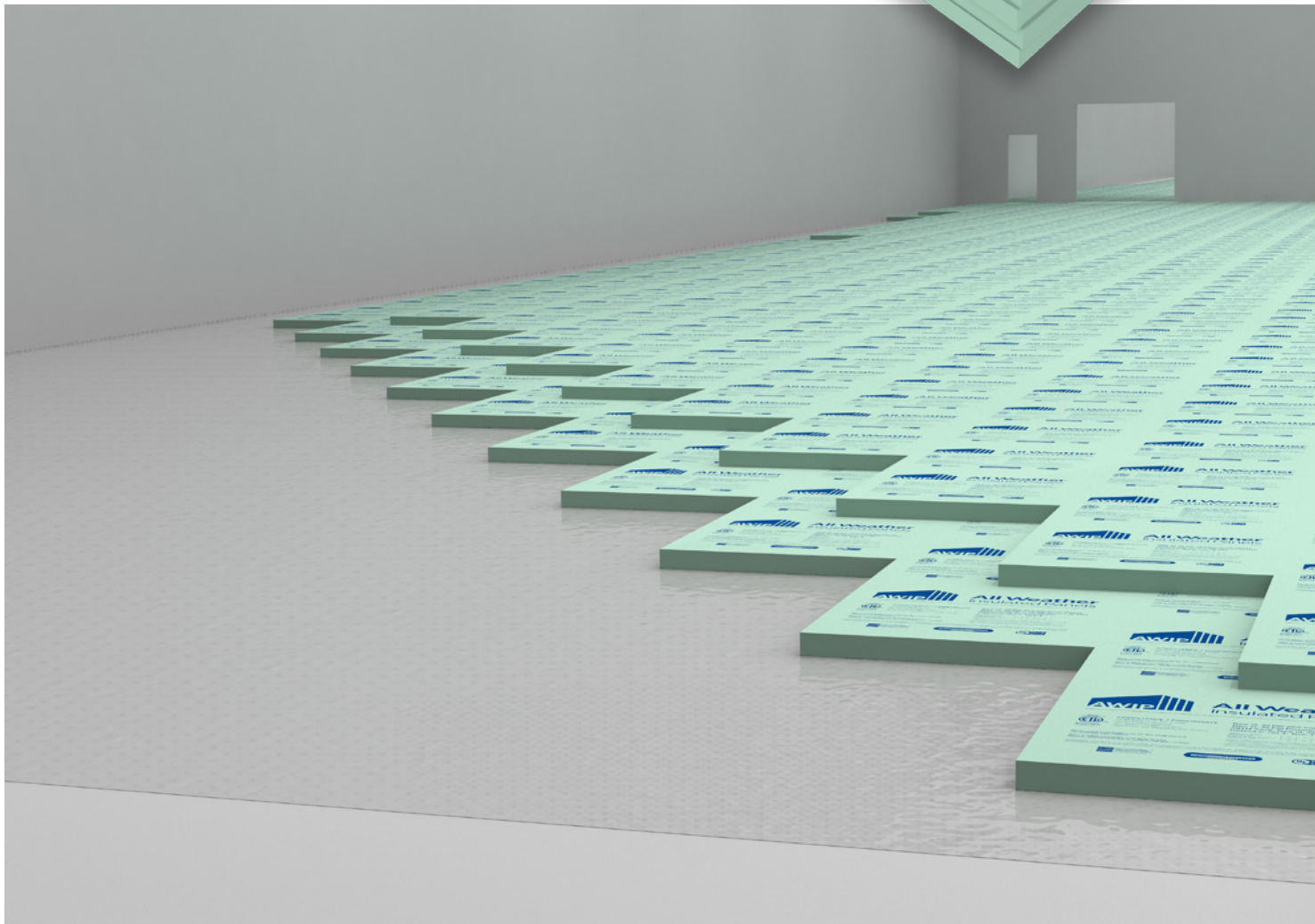

Accessories

We take care throughout our system connections to ensure performance is realized. Our comprehensive product offering is complemented by well cultivated connection details, BIM objects, installation manuals and technical support, including but not limited to fasteners, trims, clips, butyl and base angle.

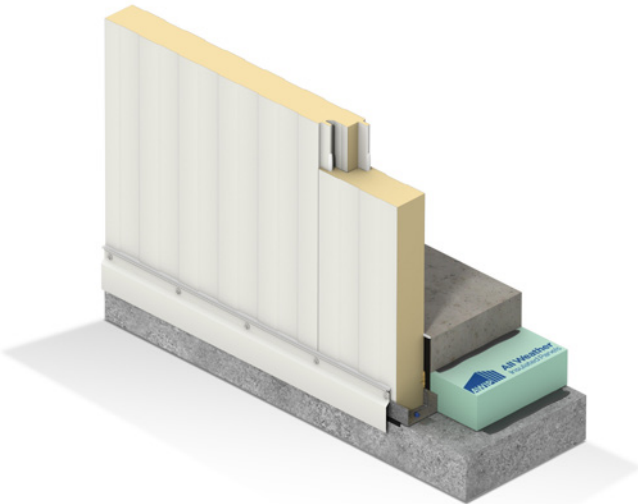

Base

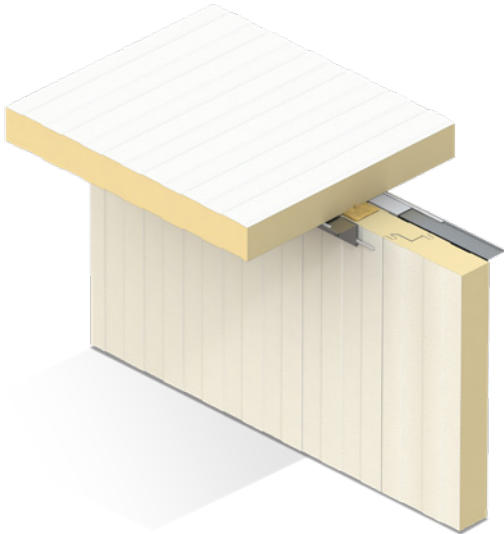

Wall to Ceiling Intersection



Long Span Clip

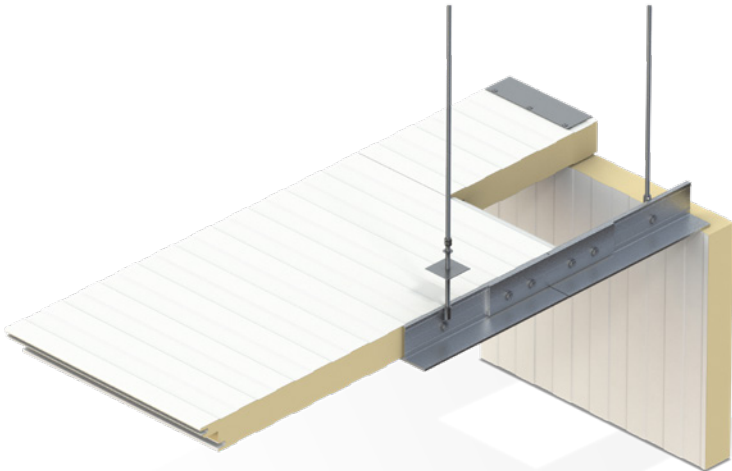

Ceiling Tee

BIM & Design Services

Our Customer First mentality means our team is available to assist you every step of the way, from design calculations through to the estimating and sales process. Go to awipanel.com/contact to get started with your sales rep today.

BIM 3D Viewer

Use our 3D Viewer to see our construction details like never before. Get a great visualization of standard finishes by selecting colors for roof and wall panels. Our convenient tool allows you to “Explode” and “Assemble” all of the various components in the detail and investigate each individual object up close. With the ability to hide or make components translucent, our easy-to-use interface provides understanding of how the components fit together.

BIM Configurator

Our BIM Configurator lets you design, configure and download BIM objects from All Weather Insulated Panels in more than 140 different formats including Revit, ArchiCAD and Tekla, as well as 2D drawings and PDF datasheets.

BIM Bundle

From insulated roof and wall panels to insulated decks, the BIM Bundle puts together a package specific to your product needs. Simply indicate your requirements, and a custom BIM Bundle will be sent to you from our digital team. With global Revit prowess and great direct product knowledge, our internal team creates and manages all the Revit project files with multiple levels of detail and materials to ensure you can deliver your product specification.



Scan to access
our BIM tools

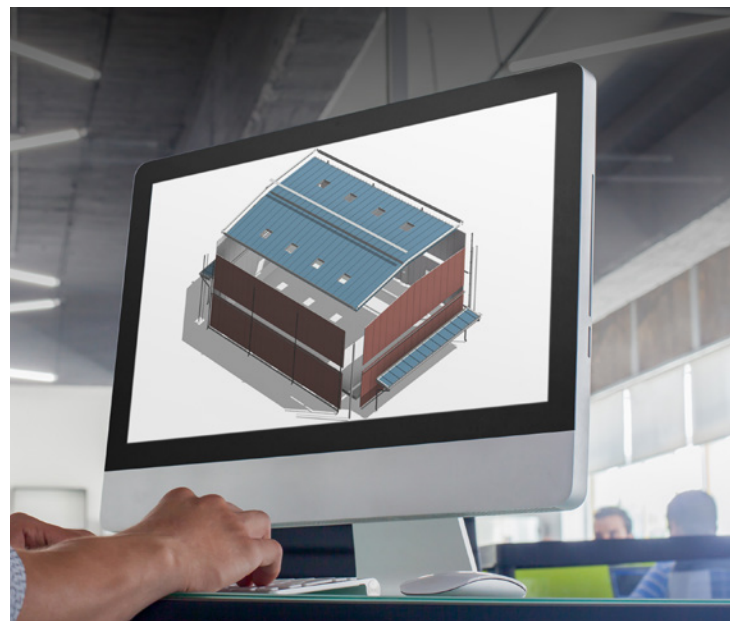

Colors & Finishes

All Weather Insulated Panels offers the colors and finishes best suited to your cold-storage needs, with careful consideration into the engineering factors of darker colors such as Royal Blue, Natural Green, Colonial Red, and Weathered Copper in cooler and freezer applications. If you need to coordinate with existing material, custom color matching is available.

In addition to our standard paint systems, All Weather can provide multilayered coil coat systems formulated to withstand a variety of aggressive environments. Specifically, these specially formulated paint finishes act not only as an excellent barrier against corrosive or extreme weather conditions but will enhance resistance to surface chalk and fade.

PVFD In-stock Colors



Sandstone

Surrey Beige

Regal White



Royal Blue

Natural Green

Pearl Gray

SMP In-stock Colors

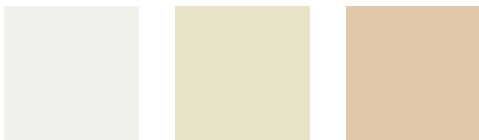

Imperial White

Sandstone

Surrey Beige

Available Non-stock Colors

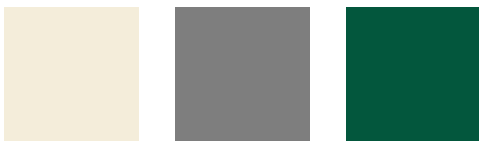

Warm White

Slate Gray

Evergreen



Slate Blue

Colonial Red

Weathered Copper

Interior Colors

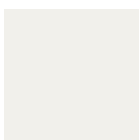

Imperial White

***For darker colors please consult AWIP for engineering and calculations.**



We Are Planet Passionate

At All Weather Insulated Panels, we are genuinely committed to our planet and making an impact on future generations. We design products that improve the efficiency of buildings, strive for net zero at our manufacturing facilities, participate in community clean-up activities and serve as a Green Business Certification Inc. (GBCI) education provider.

Our 2030 Global Commitments

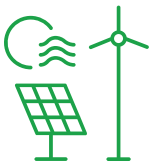

ENERGY

- Maintain our net zero energy status
- 60% direct renewable energy by 2030
- 20% on-site renewable energy generation by 2030
- Install solar PV systems on all owned facilities by 2030



CARBON

- Net zero carbon manufacturing by 2030
- 50% reduction in product CO2 intensity from our primary supply partners by 2030
- Zero emission company cars by 2025



CIRCULARITY

- 1 billion PET bottles upcycled into our manufacturing processes by 2025
- Quadcore™ products to utilize recycled PET by 2025
- Zero company waste to landfill by 2030



WATER

- 100 million liters of rainwater harvested annually by 2030
- 5 active ocean clean-up projects by 2025





Scan for the most current product information



All Weather
Insulated Panels

1 (888) 970-AWIP (2947)
awipanel.com
sales@awipanel.com



In accordance with ongoing efforts to improve our products and their performance, All Weather Insulated Panels reserves the right to change without notice the specifications contained herein. The contents herein are for general information and illustrative purposes only and are not intended to serve as any type of advice. Every effort is made to ensure the accuracy of the information included in this brochure and it is believed that the information contained herein is accurate and reliable as of the date of this publication. All Weather Insulated Panels does not warrant or represent the accuracy or reliability of any information included in this collateral. Any reliance of any information without consultation with All Weather Insulated Panels or a duly authorized representative shall be at the user's own risk. Copyright 2022 All Weather Insulated Panels — All rights reserved.