

NOTE: INSTALL POLARFAST FASTENERS 1" (MINIMUM) INBOUND OF CUT LINE PRIOR TO FIELD-RIPPING THE PANEL.

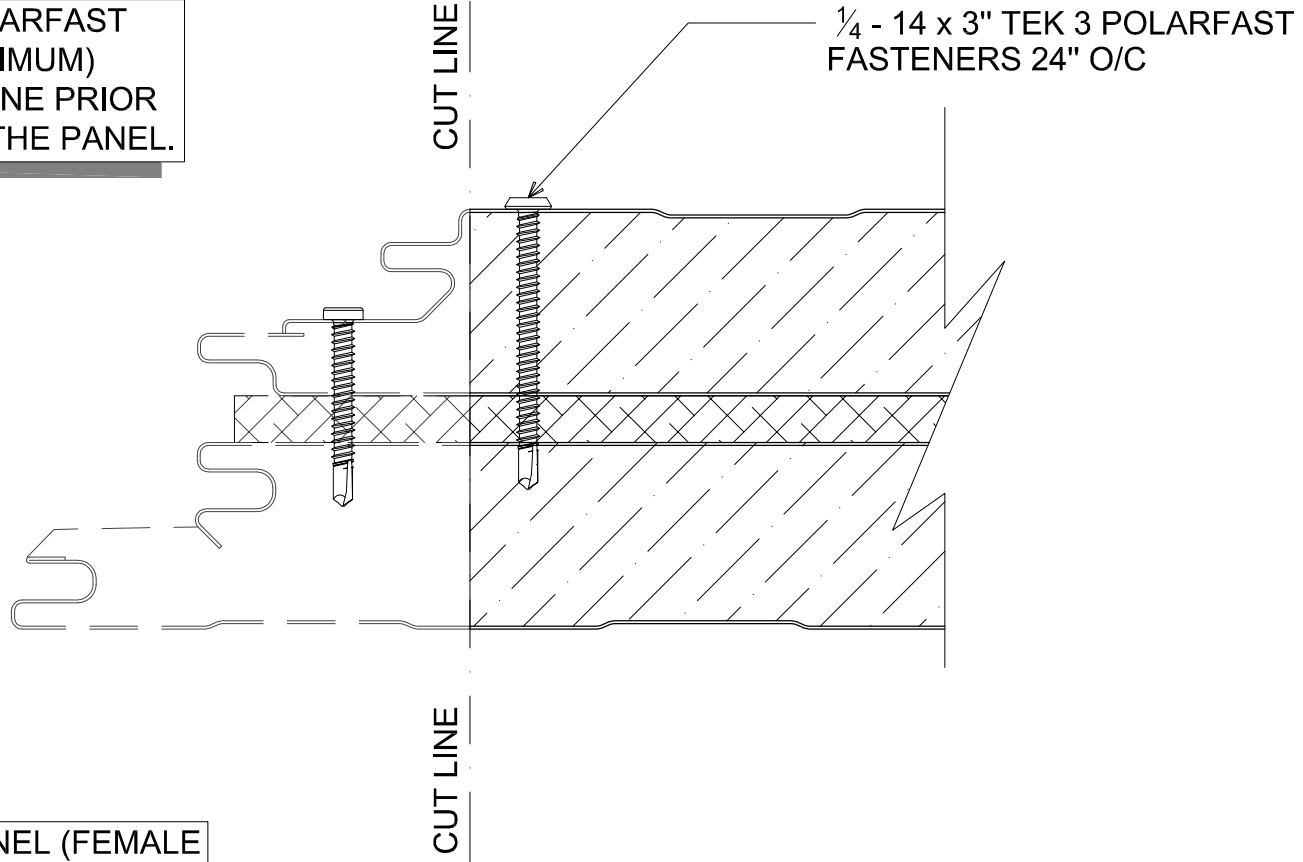

NOTE: LEADING PANEL (FEMALE JOINERY) SHOWN, FASTENING APPLIES TO ENDING PANEL (MALE JOINERY) AS WELL.

## STARTING / ENDING PANEL (FIELD-RIP DETAIL)

(PLAN VIEW)

DETAIL:

### STARTING / ENDING PANEL

APPLICATION:

VERTICAL FIRE WALL, COMMERCIAL & INDUSTRIAL, COLD-CLIMATE

AWIP DETAIL NUMBER:

FVW-CICC-SE-001

DATE:

03/25/21

DRAWN BY:

MMF

SHEET:

1

OF

929 ALDRIDGE ROAD  
VACAVILLE, CA 95688  
TEL: (707) 359-2280  
FAX: (707) 359-2286  
WWW.AWIPANELS.COM

