

**NOTE: FASTENING SCHEDULE
MAY VARY DEPENDING ON
SPECIFIC APPLICATION.**

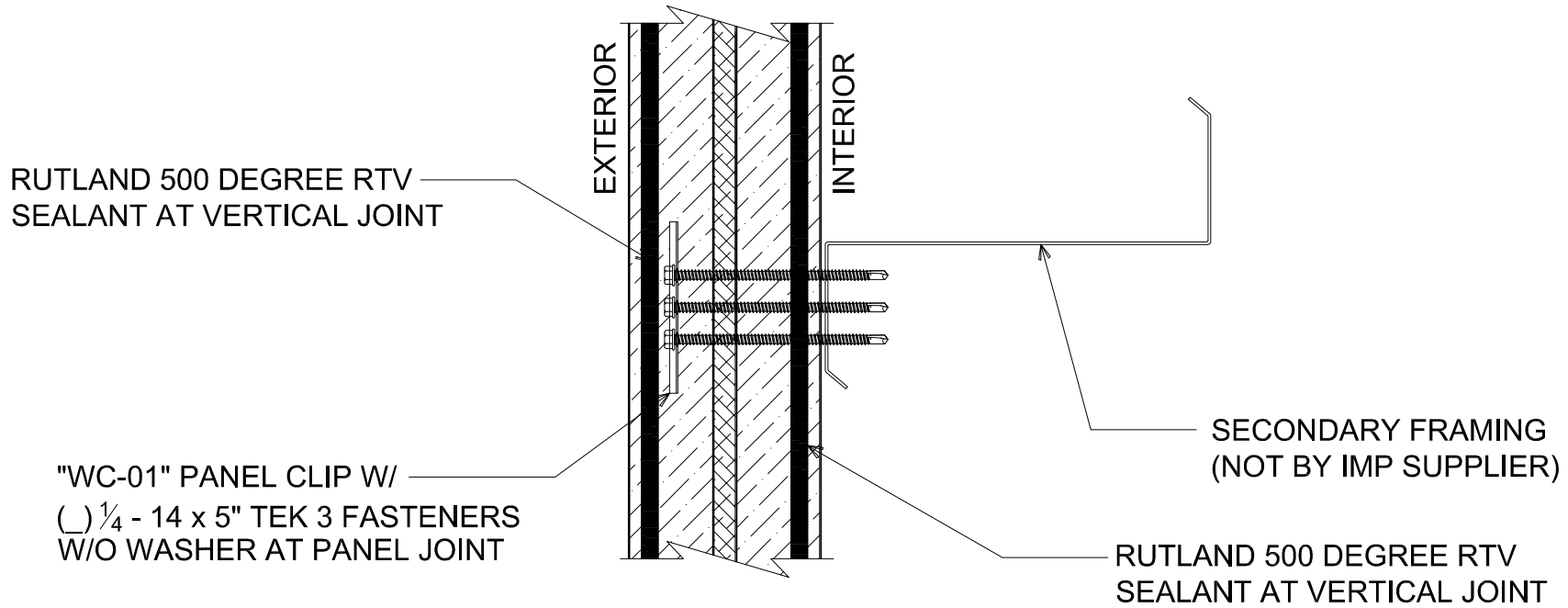

INTERMEDIATE WALL FASTENING

(SECTION VIEW)

DETAIL: **INTERMEDIATE WALL FASTENING**
 APPLICATION: VERTICAL FIRE WALL, COMMERCIAL & INDUSTRIAL, COLD-CLIMATE
 AWIP DETAIL NUMBER: FVW-CICC-IW-001

929 ALDRIDGE ROAD
 VACAVILLE, CA 95688
 TEL: (707) 359-2280
 FAX: (707) 359-2286
 WWW.AWIPANELS.COM

AWIP
 All Weather
 Insulated Panels

DATE: 04/28/22
 DRAWN BY: IMF
 SHEET: 1 OF 1

1/2" PABCO TYPE XXX
GYPSUM BOARD

FIRE SIDE

FIELD-APPLIED RUTLAND 500
DEGREE RTV SEALANT AT
FIRE SIDE

NON-FIRE SIDE

"WC-01" PANEL CLIP W/ () 1/4" - 14 x 5" TEK 3
FASTENERS W/O WASHER PER SUPPORT

FIELD-APPLIED RUTLAND 500 DEGREE
RTV SEALANT AT NON-FIRE SIDE

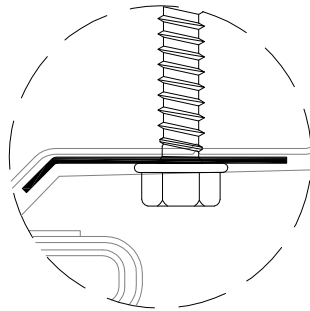

"WC-01" ORIENTATION

PANEL JOINT FASTENING

(PLAN VIEW - EXTERIOR WALL)

NOTE: FILL NON-FIRE SIDE CAVITY AND
FIRE SIDE CAVITY CONTINUOUSLY WITH
1/2" DIAMETER BEAD (APPROXIMATE) OF
RTV SEALANT (DO NOT UNDER-FILL).

DETAIL:

PANEL JOINT FASTENING

APPLICATION:
VERTICAL FIRE WALL, COMMERCIAL & INDUSTRIAL, COLD-CLIMATE
AWIP DETAIL NUMBER:
FVW-CICC-WW-001

929 ALDRIDGE ROAD
VACAVILLE, CA 95688
TEL: (707) 359-2280
FAX: (707) 359-2286
WWW.AWIPANELS.COM



SHEET:
DATE: 04/28/22
DRAWN BY: MMF

1 OF 1